

T-8DP INSERT CAVITY DETAILS
(ALL DIMENSIONS IN INCHES)
ΔM16X1.5-6H ISO (METRIC) THREAD
.5991 / .5916 PITCH DIA.

SURFACE INSTALLATION DOES NOT
NEED A PORT OR PLUG AT SURFACE.

DEEP INSTALLATION REQUIRES A
PORT FOR PLUGGING OR PLUMBING.
THE SPACE ABOVE THE CARTRIDGE
INSERT IS PORT #2. IT CAN BE
LEFT UNPLUGGED AND PLUMBED TO
EXTERNALLY OR PLUGGED AND
DRILLED INTO FROM ANOTHER
SOURCE. PORT IS NOT PART OF CAVITY
TOOLING. SMALLEST PORTS AS FOLLOWS:
.50-14 BSPP (SHOWN)
SAE-10
M22x1.5 (ISO 6149-1)
TAPERED PORTS NOT RECOMMENDED

DEEP INSTALLATION
MINIMUM RECESS SHOULD
BE MORE THAN FITTING
DEPTH INTO BODY ADDED
TO INSERT HEIGHT ABOVE
LOCATING SHOULDER (LS).
(SEE BELOW FOR THIS
DIMENSION)
MAXIMUM DEPTH TO
LOCATING SHOULDER (LS)
NO MORE THAN 3.50".
(TAP DEPTH NO MORE
THAN 3.891 FULL THREAD
DEPTH)

SURFACE
INSTALLATION
.016 MIN. RECESS
FROM MILLED
SURFACE.
.062 MIN. RECESS
FROM UNMILLED
SURFACE.
SAME AS T-8A

LOCATING
SHOULDER
.76 CARTRIDGE
HEIGHT

CARTRIDGE NOSE
SUPPORT

A		RELEASED	REVISION	DATE	DRN	CHK	REL	UNLESS OTHERWISE SPECIFIED	TITLE T-8DP DEEP CAVITY DIMENSIONS, TOOLING, PORTING	SCALE REF.	SERIES "P"	MATERIAL	REVISION A	PART NO. T-8DP INCH SHEET 1 OF 2
LET														
				29NOV11	DAS		EG8	DIMENSION TOL		2:1	CHECK	HEAT TREAT & FINISH		
							10617	.x ±.030		DAS	CL			
								.xx ±.015			RELEASE			
								.xxx ±.005						
								ANGLE TOL ± 1/2						
								FINISH 80✓						
								REMOVE ALL						
								BURRS						
				26SEP11	126SEP11									

FORM REAMER
995-008-*11
FORM DRILL
994-008-*11
.031 DRILL-REAMER
RELATIONSHIP

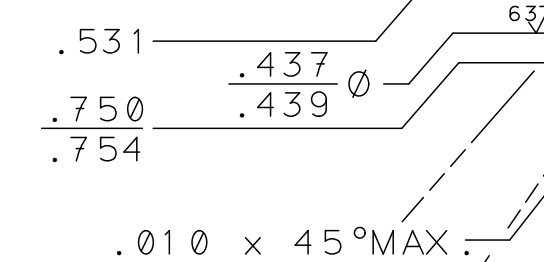
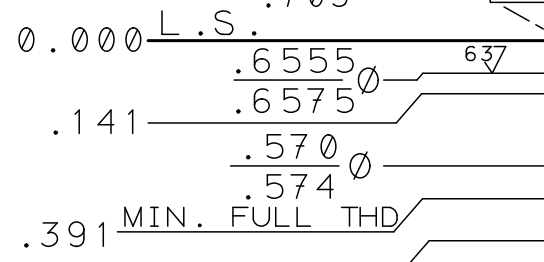
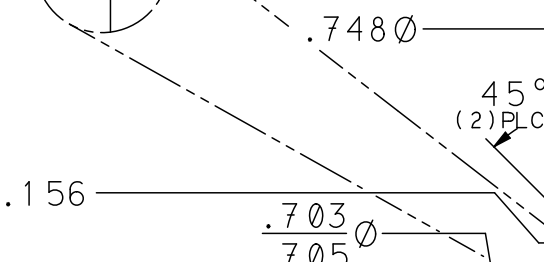
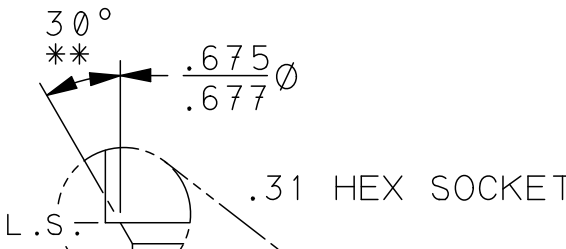

THREAD AND ALL DIAMETERS
● .002 A

MINIMUM C/L TO EDGE DISTANCE = .453
MINIMUM C/L TO C/L = .875
(IF USING A PORT AT SURFACE,
USE THE PORT MINIMUM C/L TO C/L
AND C/L TO EDGE DISTANCES)
NBOM CALLOUT: SUN STD T-8DP CAVITY
NBOM CODE: T8DP

PROPRIETARY NOTICE
THIS DRAWING DESCRIBES A
PROPRIETARY PRODUCT OF
SUN HYDRAULICS CORPORATION
AND MAY NOT BE REPRODUCED OR
GIVEN TO A THIRD PARTY WITHOUT
WRITTEN PERMISSION FROM
SUN HYDRAULICS CORPORATION
© SUN HYDRAULICS CORPORATION

**ALL O-RING "LEAD IN'S" TO
BE SMOOTH AND FREE OF NICKS
AND SHARP EDGES.